



Pop Up Tent *ECO STRUCTURES*

WANT TO KNOW MORE?

ecostructures.com.au

  @EcoStructures

24 Marine Terrace,
Fremantle,
Western Australia, 6160
+61 8 9193 8007

THE Pop Up Tent

The Pop-Up Eco Tent is changing the glamping landscape with a smart solution that delivers the ultimate versatility and durability to your site - allowing you to maximise your yearly returns.



NO APPROVALS REQUIRED

The Pop-Up Eco Tent thrives in remote locations where permanent tents aren't required, offering a quick accommodation solution that treats guests to a high level of comfort.



FAST INSTALLATION

Installation takes on average 8 hours with Eco Structures providing an extensive installation guide.



FAST ROI

Ability to charge high nightly rate equals fast return on investment.



ECO FRIENDLY

Our Pop Up tents reduce carbon footprint through the flat pack freightable design, they leave minimal impact on the ground as they are raised and the product incorporates Eco Structures GOTS Certified - Global Organic Textile Fabric, and endlessly recyclable structural steel system.

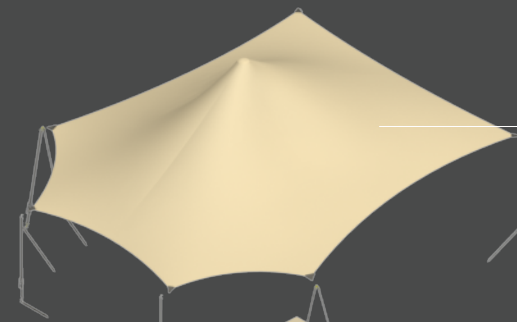

Roof Fly Options: PVC
Colour-Beige

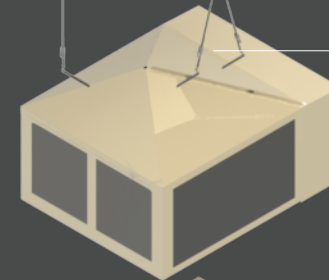

RT 12oz Canvas Body
Colour-Red Sand

Mesh Fabric windows
and doors



Ply wood Flooring

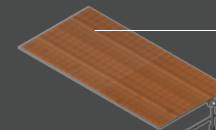

WPC Decking
Colour-Teak

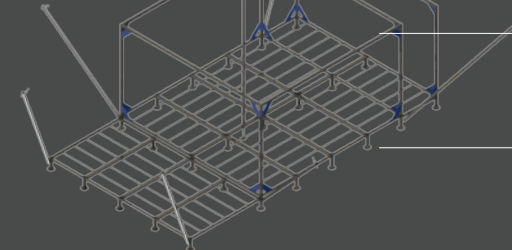

Hot dipped galvanised
structural steel frame

Adjustable Feet. Perfect
for uneven ground
(up to 100mm)

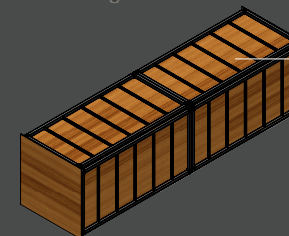

Transport Box
3.6m x 1m x 1m
Designed to deploy as the
floor



ECO STRUCTURES
LUXURY EXPERIENTIAL ACCOMMODATION

POP UP Tent





ECO STRUCTURES
LUXURY EXPERIENTIAL ACCOMMODATION

POP-UP TENT 1

3.6m x 3.6m- No Enclosure

Starting from \$15,780.00 AUD

Vinyl Flooring Addition - \$750 AUD

Internal Area	13 sqm
Deck Area 1.8m x 3.6m	6.5 sqm
Overall Roof Area	38.7 sqm
Height (Internal floor to enclosure)	2.15m
Height (Internal floor to wall)	2.3m
Height (Internal floor to ceiling)	2.9m
Imperial Size 12ft x 12ft	144sqft
Decking area 6ft x 12 ft	72sqft

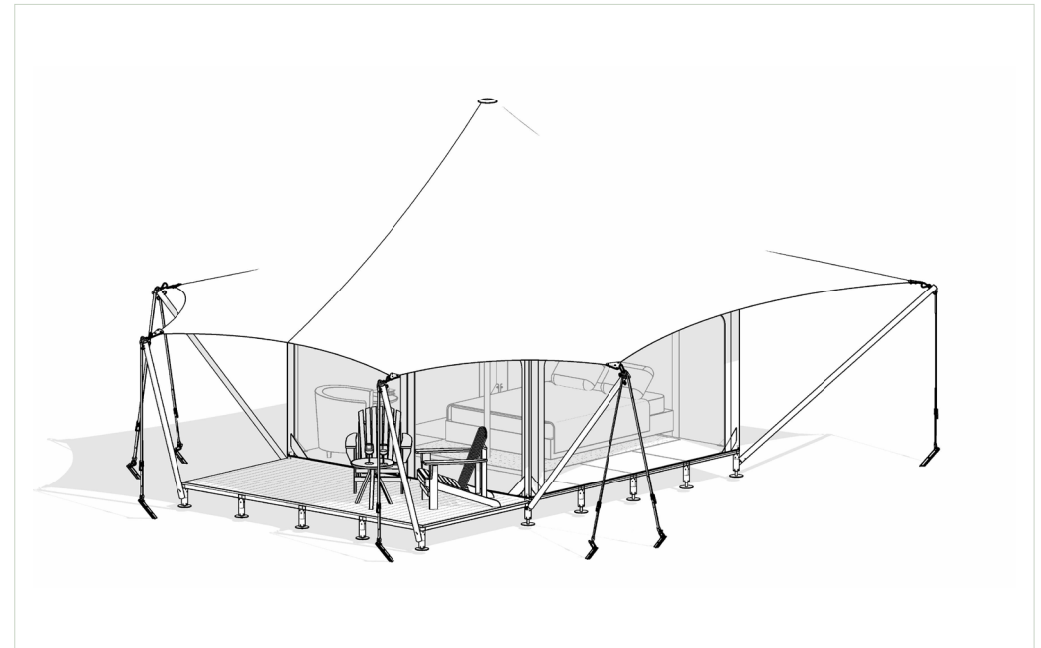
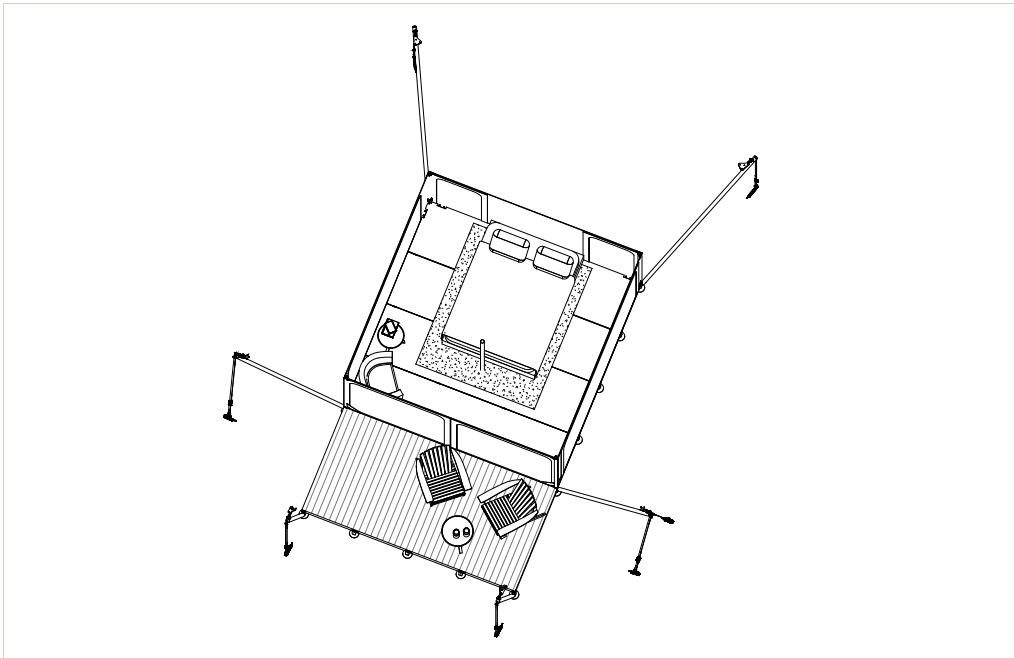

Floor Plans are presented for illustrative purposes only.



ECO STRUCTURES
LUXURY EXPERIENTIAL ACCOMMODATION

POP-UP TENT 2

3.6m x 4.8m- 1200mm Enclosure

Starting from \$19,780.00 AUD

Vinyl Flooring Addition - \$935 AUD

Internal Area	16 sqm
Deck Area 1.8m x 3.6m	6.5 sqm
Overall Roof Area	38.7 sqm
Height (Internal floor to enclosure)	2.15m
Height (Internal floor to wall)	2.3m
Height (Internal floor to ceiling)	2.9m
Height (Approx Overall)	4.4m
Imperial Size 12ft x 16ft	192sqf
Decking area 6ft x 12 ft	72sqf

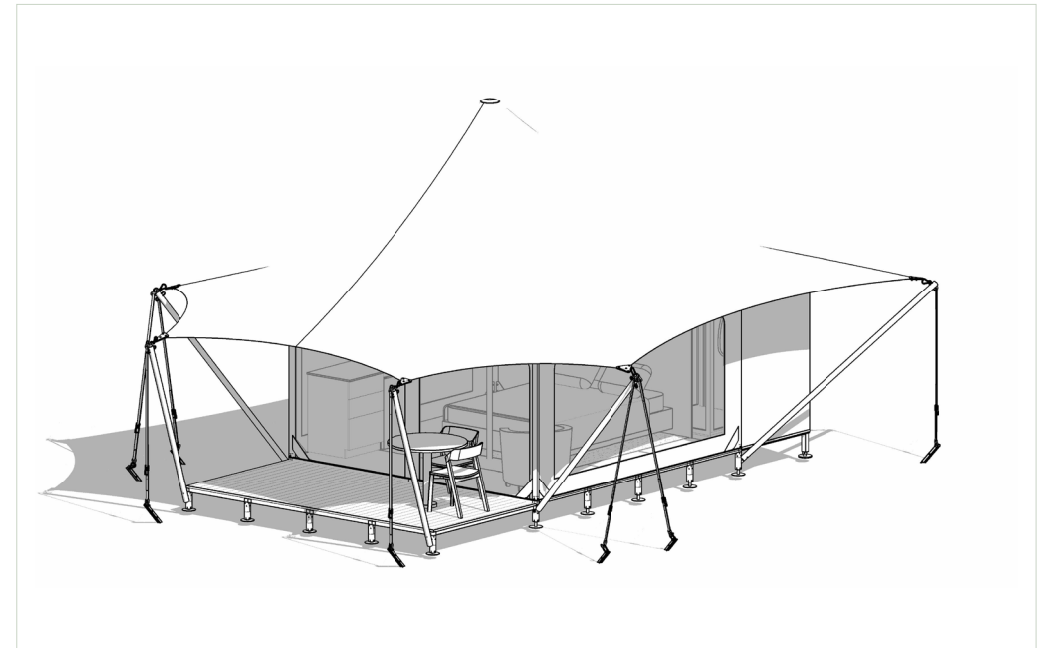
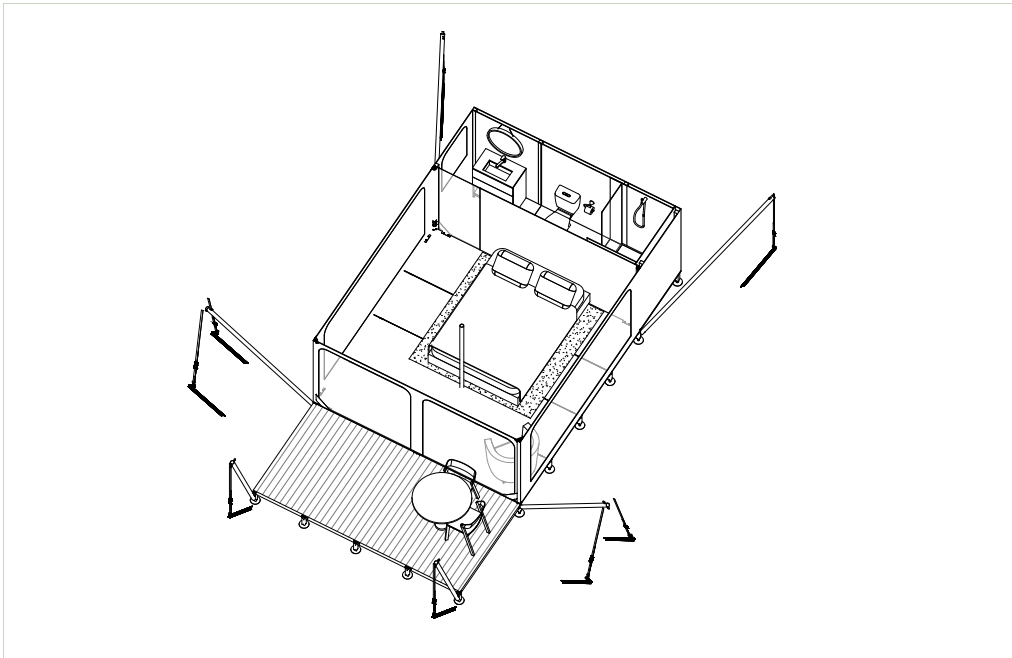

Floor Plans are presented are for illustrative purposes only.



ECO STRUCTURES
LUXURY EXPERIENTIAL ACCOMMODATION

POP-UP TENT 3

5.4m x 3.6m- x2 900mm Enclosures

Starting from \$23,780.00 AUD

Vinyl Flooring Addition - \$1,100 AUD

Internal Area	19.5 sqm
Deck Area 1.8m x 3.6m	6.5 sqm
Overall Roof Area	38.7 sqm
Height (Internal floor to enclosure)	2.15m
Height (Internal floor to wall)	2.3m
Height (Internal floor to ceiling)	2.9m
Height (Approx Overall)	4.4m
Imperial Size 18ft x 12ft	216sqf
Decking area 6ft x 12 ft	72sqf

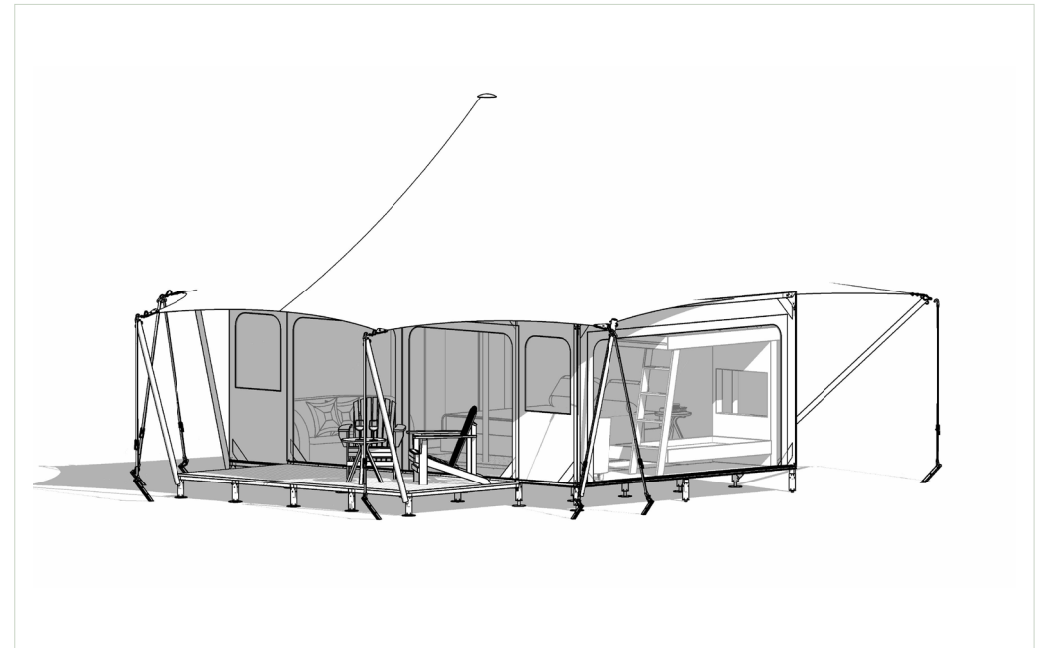
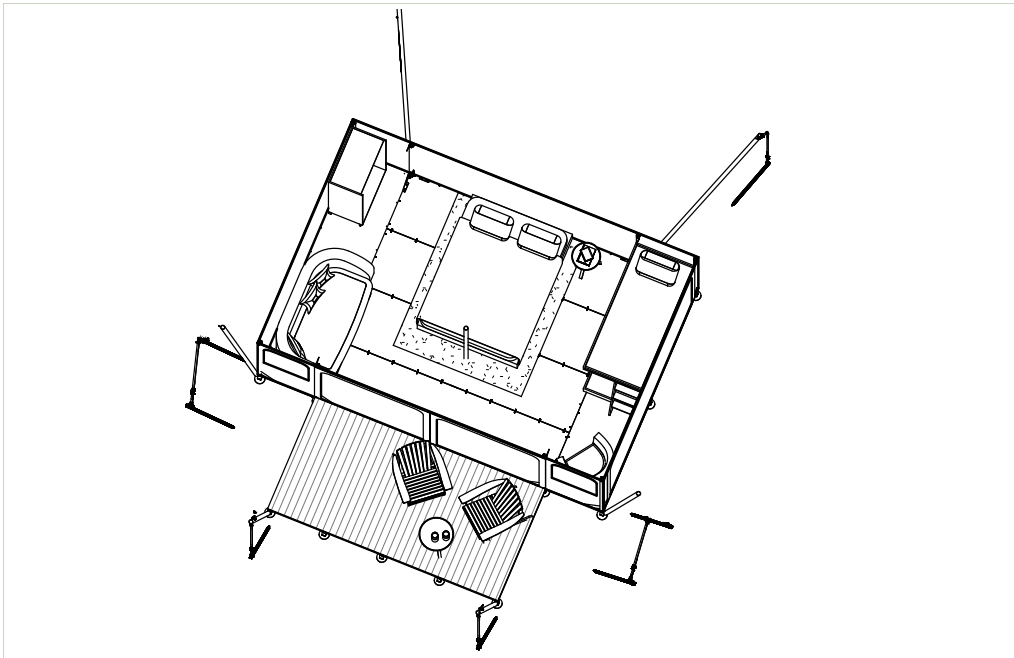

Floor Plans are presented are for illustrative purposes only.



ECO STRUCTURES
LUXURY EXPERIENTIAL ACCOMMODATION

POP-UP TENT 4

4.8m x 4.5m-

x1 900mm Enclosure

x1 1200mm Enclosure

Starting from \$23,780.00 AUD

Vinyl Flooring Addition - \$1,100 AUD

Internal Area	20 sqm
Deck Area 1.8m x 3.6m	6.5 sqm
Overall Roof Area	38.7 sqm
Height (Internal floor to enclosure)	2.15m
Height (Internal floor to wall)	2.3m
Height (Internal floor to ceiling)	2.9m
Height (Approx Overall)	4.4m
Imperial Size 18ft x 12ft	216sqf
Decking area 6ft x 12 ft	72sqf

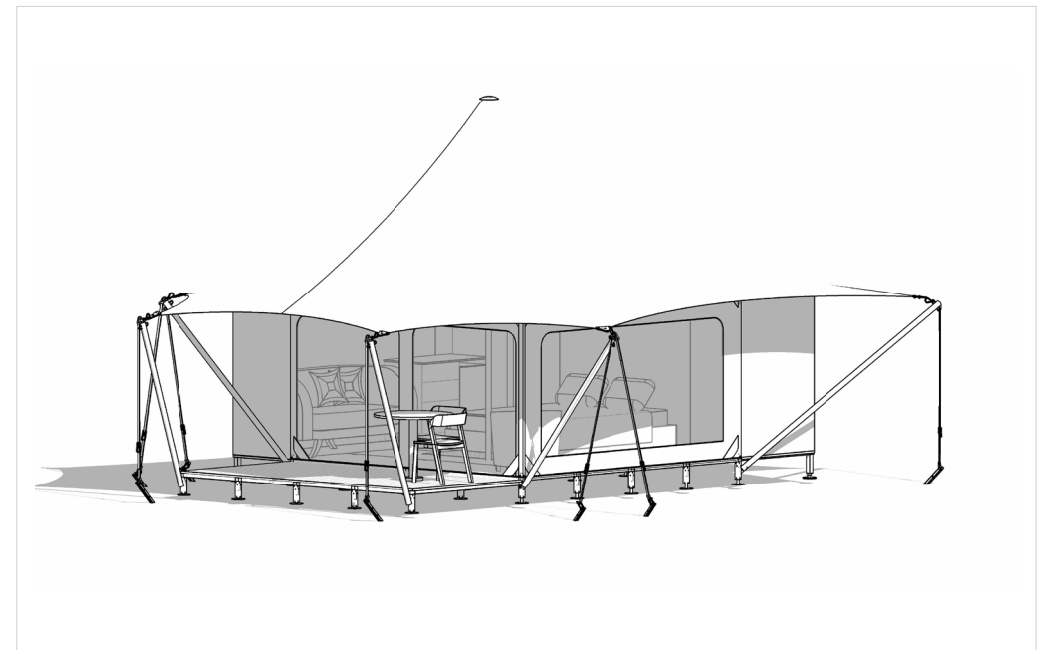
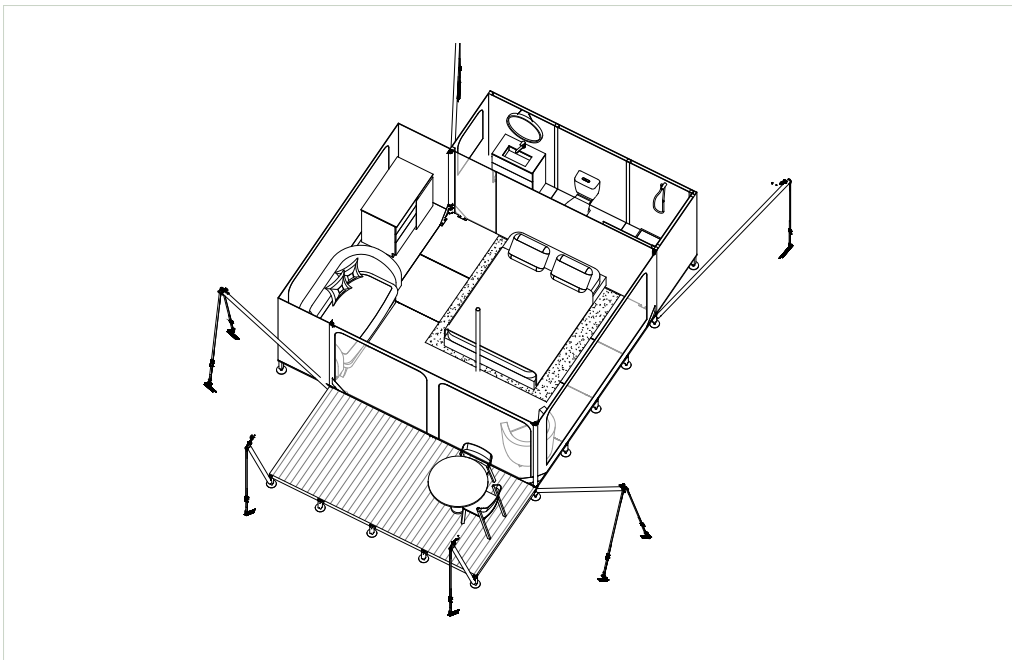

Floor Plans are presented are for illustrative purposes only.

Supply- INCLUSIONS

We **INCLUDE** almost everything you need to develop your project.

PRODUCT INCLUSIONS

- Sub floor hot tipped galvanised steel structure as transport Box
- Ply wood internal flooring WPC externally
- 22 adjustable feet
- Galvanised structural steel frame and poles
- PVC roofing ropes, rigging and ratchet straps

SERVICE INCLUSIONS

- Warranties
- Installation Guide
- Shipping support to your choice of port (additional charges)
- Local transport from port to site (To be advised as per country & project specifications)

PRODUCT SPECIFICATIONS

Pale Beige

Red Sand

Teak

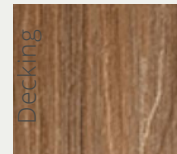
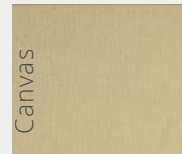
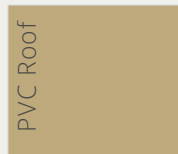

SERVICE EXCLUSIONS

- Import duties & clearance
- Connections to power, water and other infrastructural needs
- Land & Access- *Site preparation as per our suggestions*
- Local Labour- *Eco Structures can provide construction managers*
- Furniture, cabinetry etc.

WARRANTY



Floor Joist and Bearers- Blue Scope Lysaght 200C

10 Year Limited Warranty

20 Year Estimated Life



Hot Dipped Galvanized Structural Steel Frame

15 Year Limited Warranty

25-50 Year Estimated Life



RT12 Canvas

5 Year Limited Warranty

10-12 Year Estimated Life



Flooring WPC External Board

5 Year Limited Warranty

10 Year Estimated Life



ECO STRUCTURES
LUXURY EXPERIENTIAL ACCOMMODATION

Frequently Asked *QUESTIONS*



LEAD TIME

Our lead time is 90-120 days to manufacture | 4 weeks shipping | 1 day to install



INTERNAL FLOORING

We supply ply wood flooring as standard, however you may choose to vinyl, tile or deck the floor.



GROUND CONDITIONS

The site chosen for install must be a level site. Each footing at the base has 100mm of adjustment in the event of a slightly unlevel site.



CARE & MAINTENANCE

The maintenance required for Glamping Tents is minimal. Store bought products can be used to clean any marks.



REPLACEMENT PARTS

We offer replacement canvas panels, decking and roof flys for when there is a need. Just remove the current panel or part and replace with a new panel.



BED SIZE

A double or queen sized bed can fit perfectly. The Distance from the back wall to the pole is 2200mm (90.5in)



HEATING & COOLING

Our Glamping Tents can be heated or cooled with split system airconditionin, or a fireplace for the cooler climates.



WIND & FIRE RATINGS



The pop-up is rated to 100km/hr winds. When winds are expected to be higher than this, it is advised to dismantle the pop-up as warranty is removed.



STRUCTURAL SYSTEM

Hot dipped galvanised structural steel frame, with 15 Years Warranty.

WANT TO KNOW MORE?
ecostructures.com.au

  @EcoStructures

24 Marine Terrace, Fremantle,
Western Australia, 6160
+61 8 9193 8007

GO BEYOND

A company of The WABi Group

W A B I W A B I W A B I W A B I
SIMPLER. SMARTER. STRONGER DESIGN CONSTRUCTIONS WINDOWS

© 2023 Eco Structures