



# Leaf Tent *ECO STRUCTURES*

**WANT TO KNOW MORE?**  
[ecostructures.com.au](http://ecostructures.com.au)

  @EcoStructures

24 Marine Terrace,  
Fremantle,  
Western Australia, 6160  
+61 8 9193 8007

# THE Leaf Tent

Introducing the Leaf Tent – a sustainable, innovative design that reimagines traditional building materials and incorporates nature into the structure of a building.

The Leaf Tent features a unique ribbed spine that securely holds PVC material, creating a leaf-like pattern that covers and envelops the entire building.



## EXPERIENTIAL

Inspired by the beauty of nature, this leaf tent embraces the biophilic approach. Soft earthy tones, natural textures, and organic materials foster connection with the surrounding ecosystem.



## MENTAL HEALTH BENEFITS

The leaf roof, combined with the healing presence of nature, invites individuals to disconnect, rejuvenate, and rediscover their inner equilibrium. Here, tranquility and serenity converge, nurturing mental well-being and offering a profound sense of peace.



## GREENER FOOTPRINT

The Leaf Tent incorporates Eco Structures eco-friendly system, using Eco Anchors, GOTS Certified - Global Organic Textile Fabric, endlessly recyclable structural steel system and reducing carbon footprint through flatpack designs.

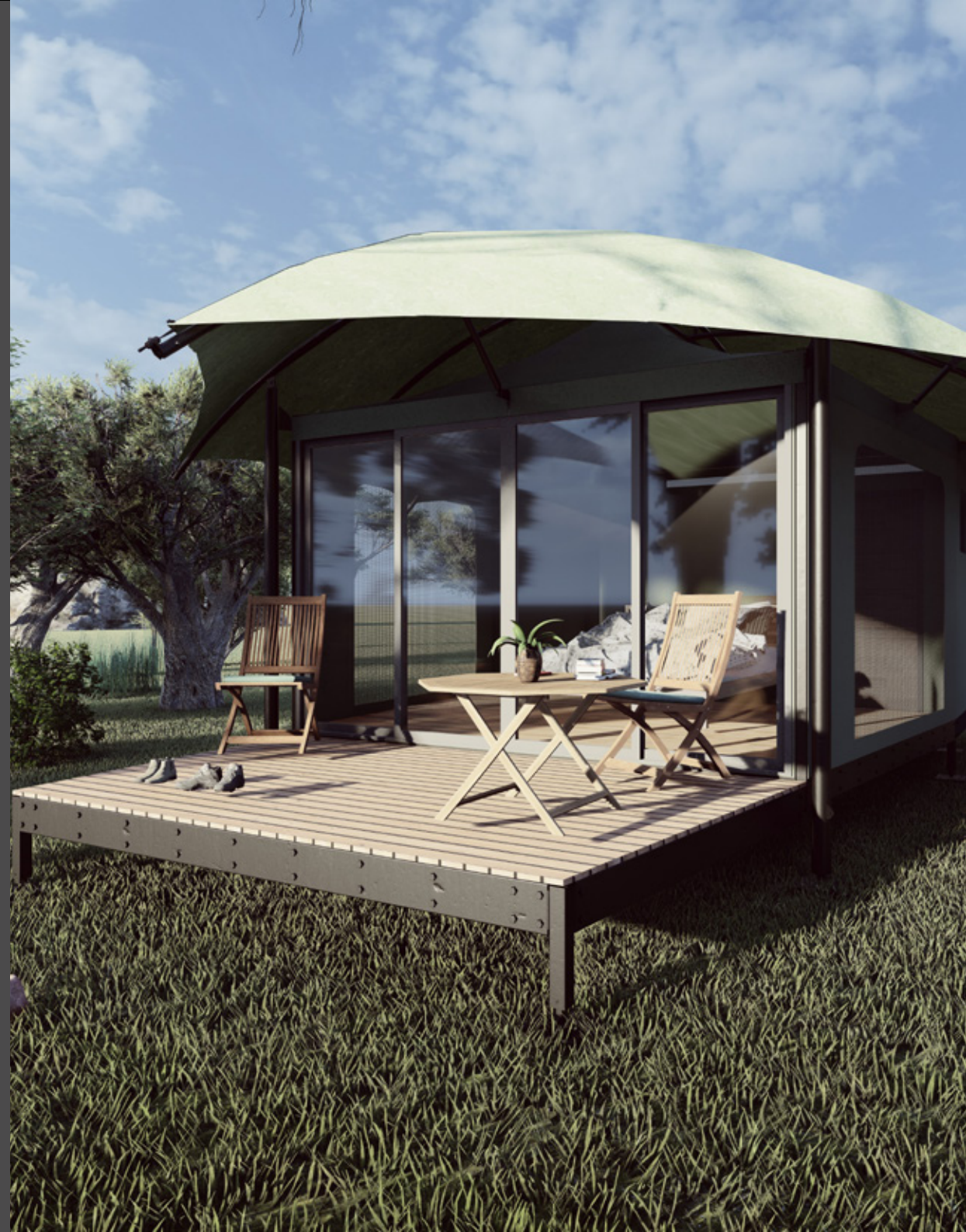

# *THE* Leaf Tent



# LEAF ECO TENT

5.5m x 7.4m

Leaf Tent 5.5m x 7.4m		
Item - Supply Only	Unit	Total (AUD)
5.5m x 7.4m Eco Leaf Tent	1	\$45,200
<ul style="list-style-type: none"> <li>PVC Leaf Roof</li> <li>Canvas Ceiling + Walls</li> <li>Steel structural frame – hot dipped galvanised steel</li> <li>All fixings required for install</li> </ul>		
Deck 2.7m x 5.5m	1	\$7,500
<b>TOTAL</b>	<b>1 Unit</b>	<b>\$52,700</b>
UPGRADES / ADDITIONS		
Vinyl Flooring	1	\$2,200
Balustrade	1	\$7,500
Eco Anchor Foundation x 12	12	\$2,100
Glass Front Doors w Upgraded Handle	1	\$8,350

\*Please note - All prices are in AUD, and exclude, instalation, plumbing, electrical works and civil works.  
No allowance for concrete footings have been made if rock is present.  
Internal floor layouts shown for illustrative purposes only.  
Subject to engineering and design specification changes.

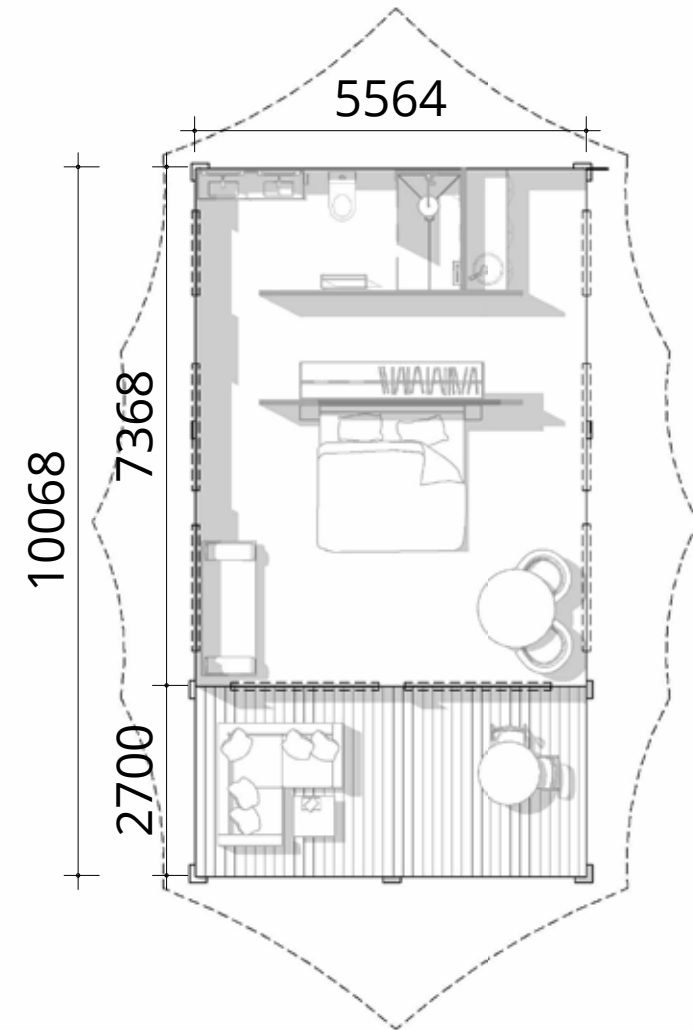

\*Please note - All prices are in AUD, and exclude, instalation, plumbing, electrical works and civil works.  
 No allowance for concrete footings have been made if rock is present.  
 Internal floor layouts shown for illustrative purposes only.  
 Subject to engineering and design specification changes.

# LEAF HYBRID TENT

5.5m x 7.4m

Leaf Tent 5.5m x 7.4m		
Item - Supply Only	Unit	Total (AUD)
5.5m x 7.4m Hybrid Leaf Tent	1	\$72,050
<ul style="list-style-type: none"> <li>• PVC Leaf Roof</li> <li>• WABi Thermal Insulated Panels</li> <li>• Insulated Canvas Ceiling</li> <li>• Canvas External Walls</li> <li>• Front Sliding Doors</li> <li>• Steel structural frame – hot dipped galvanised steel</li> <li>• All fixings required for install</li> </ul>		
Deck 2.7m x 5.5m	1	\$7,500
<b>TOTAL</b>	<b>1 Unit</b>	<b>\$79,550</b>
UPGRADES / ADDITIONS		
Vinyl Flooring	1	\$2,200
Balustrade	1	\$7,500
Eco Anchor Foundation x 12	12	\$2,100
Canvas Internal Lining	Per LM	\$330

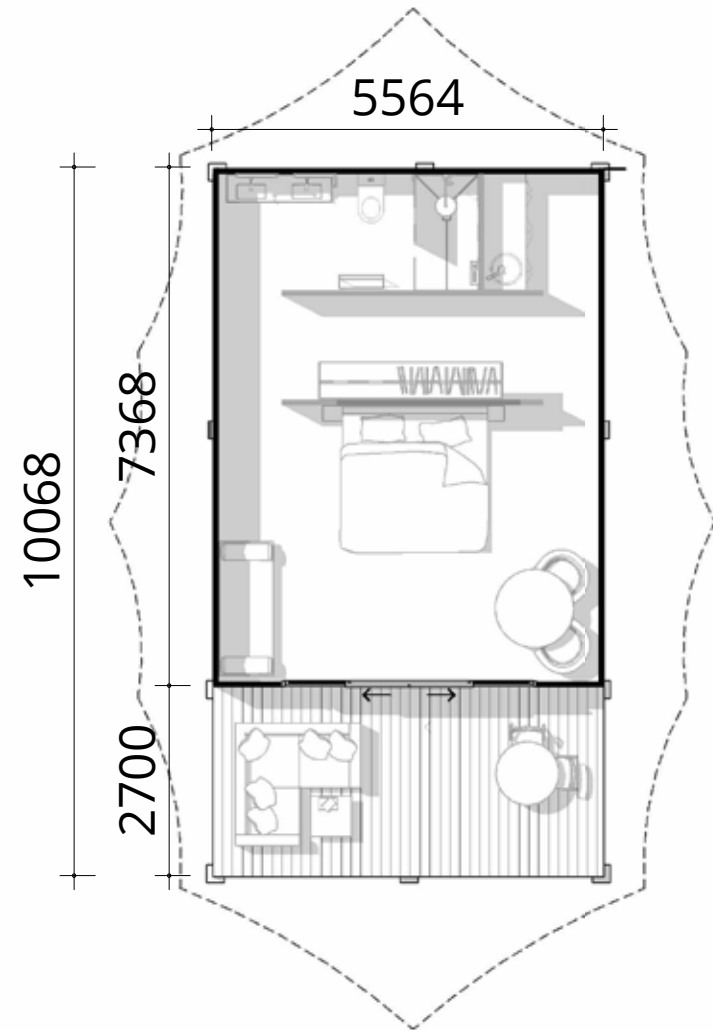

# LEAF ECO TENT

5.5m x 10m

Leaf Tent 5.5m x 10m		
Item - Supply Only	Unit	Total (AUD)
5.5m x 10m Eco Leaf Tent	1	\$58,900
<ul style="list-style-type: none"> <li>• PVC Leaf Roof</li> <li>• Canvas Ceiling + Walls</li> <li>• Steel structural frame – hot dipped galvanised steel</li> <li>• All fixings required for install</li> </ul>		
Deck 2.7m x 5.5m	1	\$7,500
<b>TOTAL</b>	<b>1 Unit</b>	<b>\$66,400</b>
UPGRADES / ADDITIONS		
Vinyl Flooring	1	\$2,200
Balustrade	1	\$7,500
Eco Anchor Foundation x 12	12	\$2,100
Glass Front Doors w Upgraded Handle	1	\$8,350

\*Please note - All prices are in AUD, and exclude, instalation, plumbing, electrical works and civil works. No allowance for concrete footings have been made if rock is present. Internal floor layouts shown for illustrative purposes only. Subject to engineering and design specification changes.

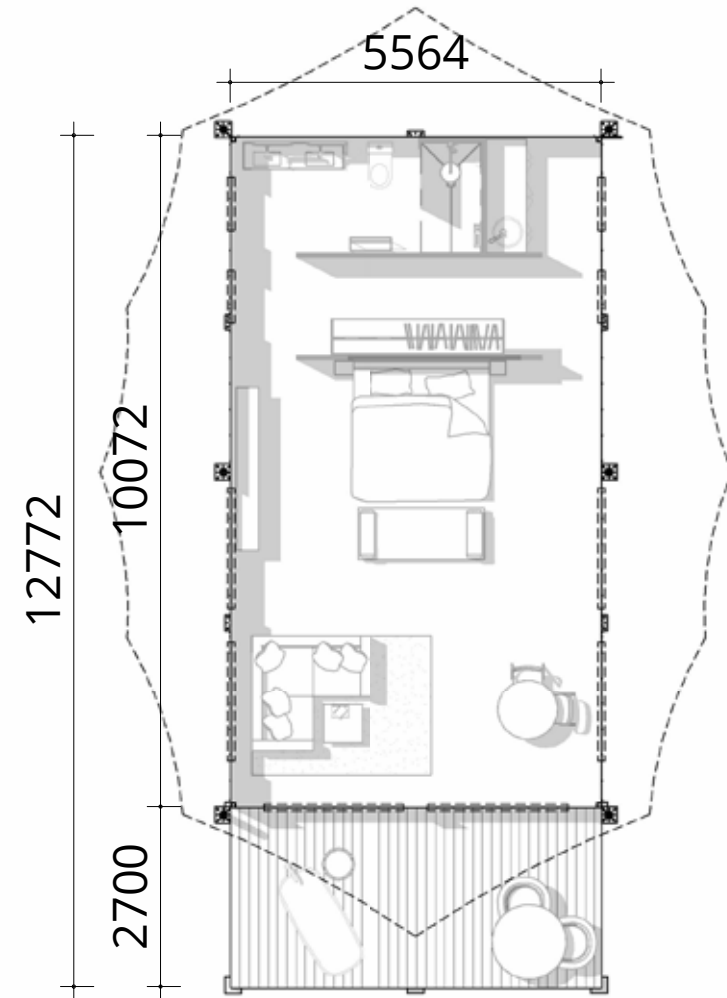

# LEAF HYBRID TENT

5.5m x 10m

Leaf Tent 5.5m x 10m		
Item - Supply Only	Unit	Total (AUD)
5.5m x 10m Hybrid Leaf Tent	1	\$94,300
<ul style="list-style-type: none"> <li>PVC Leaf Roof</li> <li>WABi Thermal Insulated Panels</li> <li>Insulated Canvas Ceiling</li> <li>Canvas External Walls</li> <li>Front Sliding Doors</li> <li>Steel structural frame – hot dipped galvanised steel</li> <li>All fixings required for install</li> </ul>		
Deck 2.7m x 5.5m	1	\$7,500
<b>TOTAL</b>	<b>1 Unit</b>	<b>\$101,800</b>
UPGRADES / ADDITIONS		
Vinyl Flooring	1	\$2,200
Balustrade	1	\$7,500
Eco Anchor Foundation x 12	12	\$2,100
Canvas Internal Lining	Per LM	\$330

\*Please note - All prices are in AUD, and exclude, instalation, plumbing, electrical works and civil works.  
No allowance for concrete footings have been made if rock is present.  
Internal floor layouts shown for illustrative purposes only.  
Subject to engineering and design specification changes.

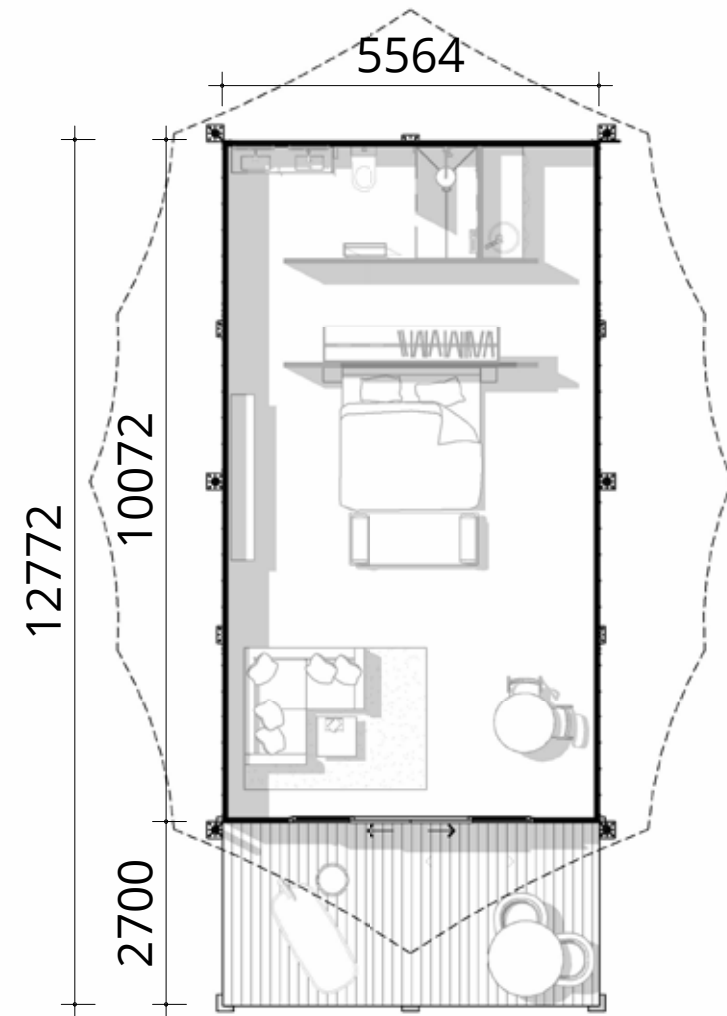

# LEAF ECO TENT

Horizontal 5.5m x 10m

Leaf Tent 5.5m x 10m		
Item - Supply Only	Unit	Total (AUD)
5.5m x 10m Eco Leaf Tent	1	\$58,900
<ul style="list-style-type: none"> <li>PVC Leaf Roof</li> <li>Canvas Ceiling + Walls</li> <li>Steel structural frame – hot dipped galvanised steel</li> <li>All fixings required for install</li> </ul>		
Deck 2.7m x 10m	1	\$12,300
<b>TOTAL</b>	<b>1 Unit</b>	<b>\$71,200</b>
UPGRADES / ADDITIONS		
Vinyl Flooring	1	\$2,200
Balustrade	1	\$7,500
Eco Anchor Foundation x 12	12	\$2,100
Glass Front Doors w Upgraded Handle	1	\$8,350

\*Please note - All prices are in AUD, and exclude, instalation, plumbing, electrical works and civil works. No allowance for concrete footings have been made if rock is present. Internal floor layouts shown for illustrative purposes only. Subject to engineering and design specification changes.

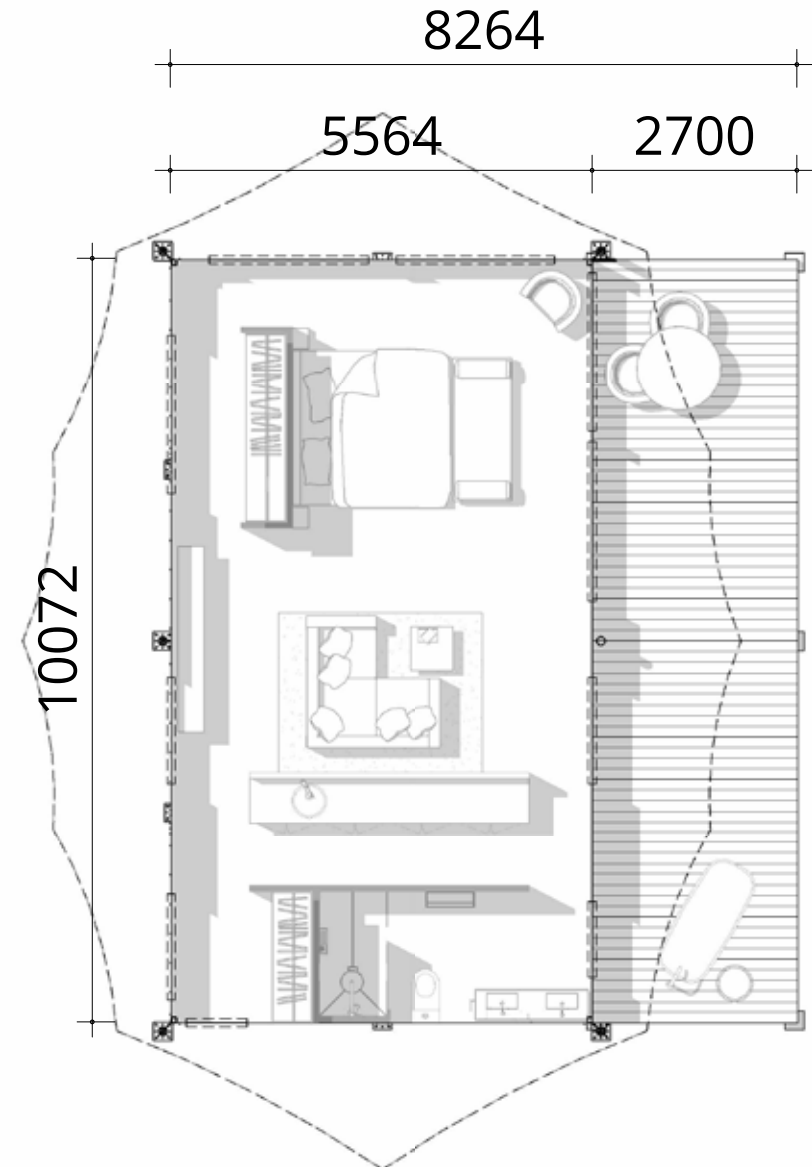



*\*Please note - All prices are in AUD, and exclude, instalation, plumbing, electrical works and civil works.  
No allowance for concrete footings have been made if rock is present.  
Internal floor layouts shown for illustrative purposes only.  
Subject to engineering and design specification changes.*

# LEAF HYBRID TENT

Horizontal 5.5m x 10m

Leaf Tent 5.5m x 10m		
Item - Supply Only	Unit	Total (AUD)
5.5m x 10m Hybrid Leaf Tent	1	\$94,300
<ul style="list-style-type: none"> <li>• PVC Leaf Roof</li> <li>• WABi Thermal Insulated Panels</li> <li>• Insulated Canvas Ceiling</li> <li>• Canvas External Walls</li> <li>• Front Sliding Doors</li> <li>• Steel structural frame – hot dipped galvanised steel</li> <li>• All fixings required for install</li> </ul>		
Deck 2.7m x 10m	1	\$12,300
<b>TOTAL</b>	<b>1 Unit</b>	<b>\$106,600</b>
UPGRADES / ADDITIONS		
Vinyl Flooring	1	\$2,200
Balustrade	1	\$7,500
Eco Anchor Foundation x 12	12	\$2,100
Canvas Internal Lining	Per LM	\$330

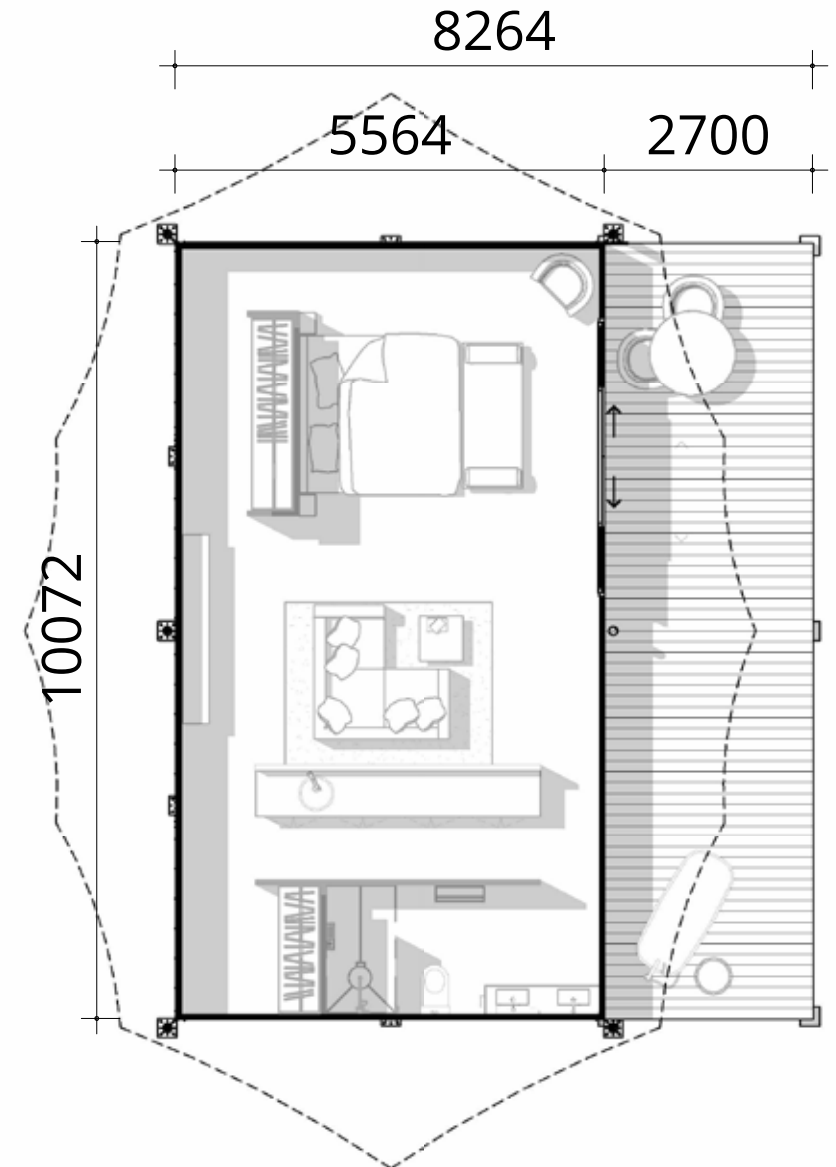

# LEAF TENT Comparison

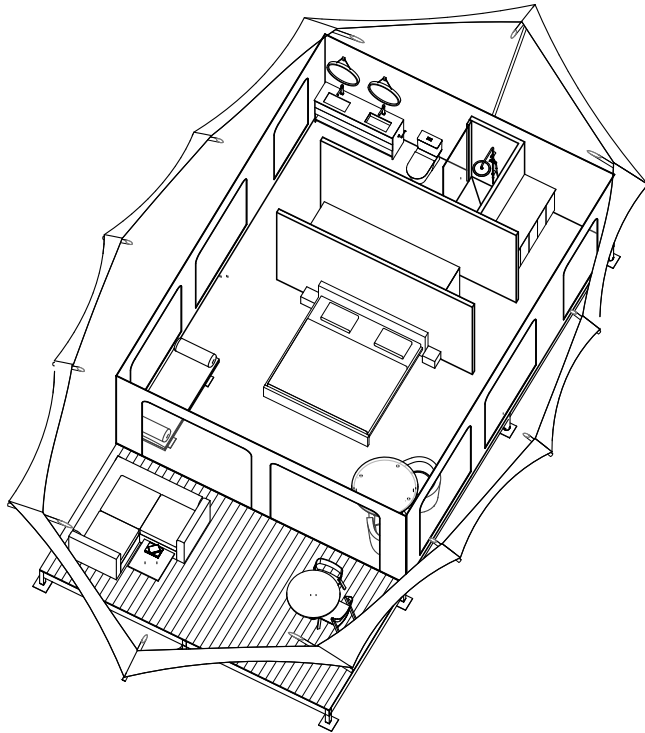

 5.5M X 7.4M

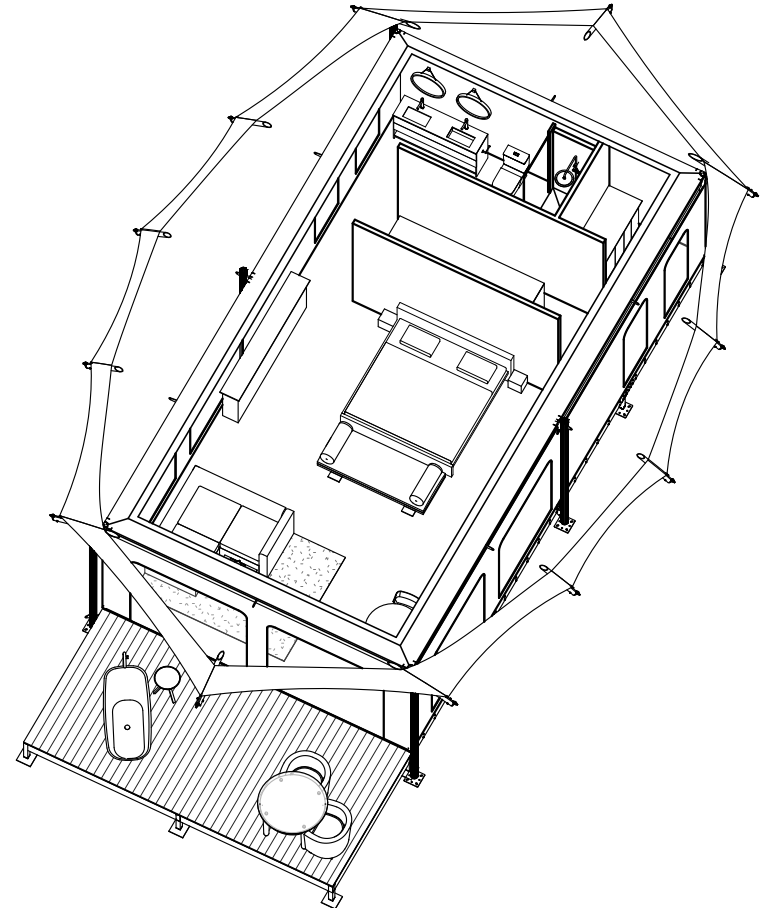

 5.5M X 10M

## ECO TENT INCLUSIONS

- PVC Roof
- Canvas Ceiling and Walls
- Mesh doors and windows
- Steel structural frame – hot dipped galvanised steel
- All fixings required for install

## HYBRID TENT INCLUSIONS

- PVC Roof
- Canvas Insulated Ceiling
- WABi Panels
- External Canvas Cladding
- Glass Sliding Doors
- Steel structural frame – hot dipped galvanised steel
- All fixings required for install

## SERVICE INCLUSIONS

- Warranties
- Architectural & Engineering drawings
- Shipping support to your choice of port (additional charges)
- Local transport from port to site (To be advised as per country & project specifications)

## SERVICE EXCLUSIONS

- Land & Access- Site preparation as per our suggestions
- Local Labour- Eco Structures can provide construction managers
- Architectural support- Eco Structures can provide at an additional Charge

# WARRANTY



### **WABi Wall Panels**

7 Year Limited Warranty

20 Year Estimated Life



### **Floor Joist and Bearers- Blue Scope Lysaght 200C**

10 Year Limited Warranty

20 Year Estimated Life



### **Hot Dipped Galvanized Structural Steel Frame**

15 Year Limited Warranty

25-50 Year Estimated Life



### **Eco Anchor**

10 Year Limited Warranty

50 Year Structural Design Warranty



### **RT12 Canvas**

5 Year Limited Warranty

10-12 Year Estimated Life



### **Flooring WPC External Board**

5 Year Limited Warranty

10 Year Estimated Life

# ECO TENT VS HYBRID TENT

## Exploded View

### Eco Tent

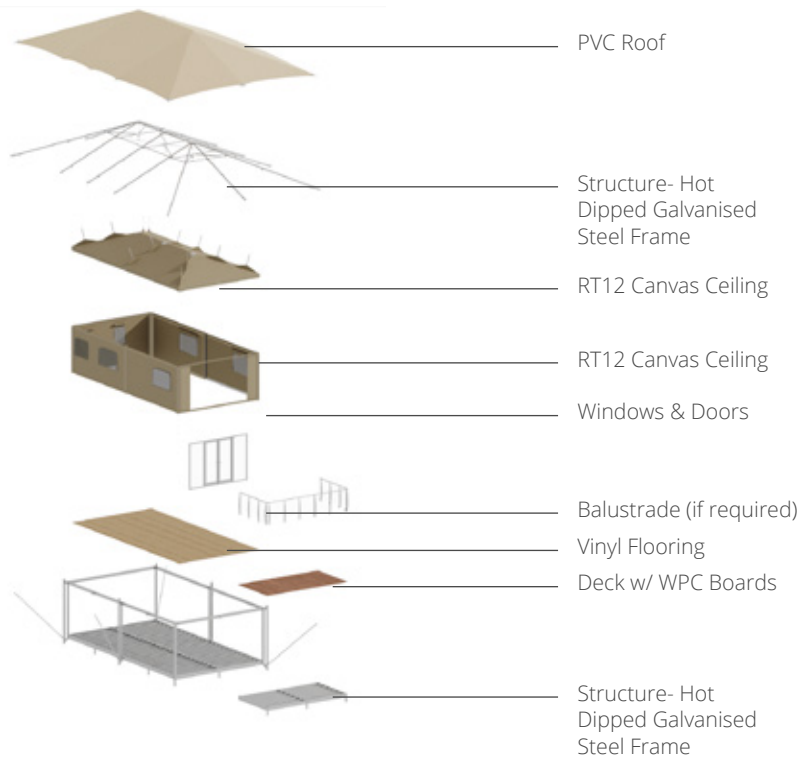

### Hybrid Tent

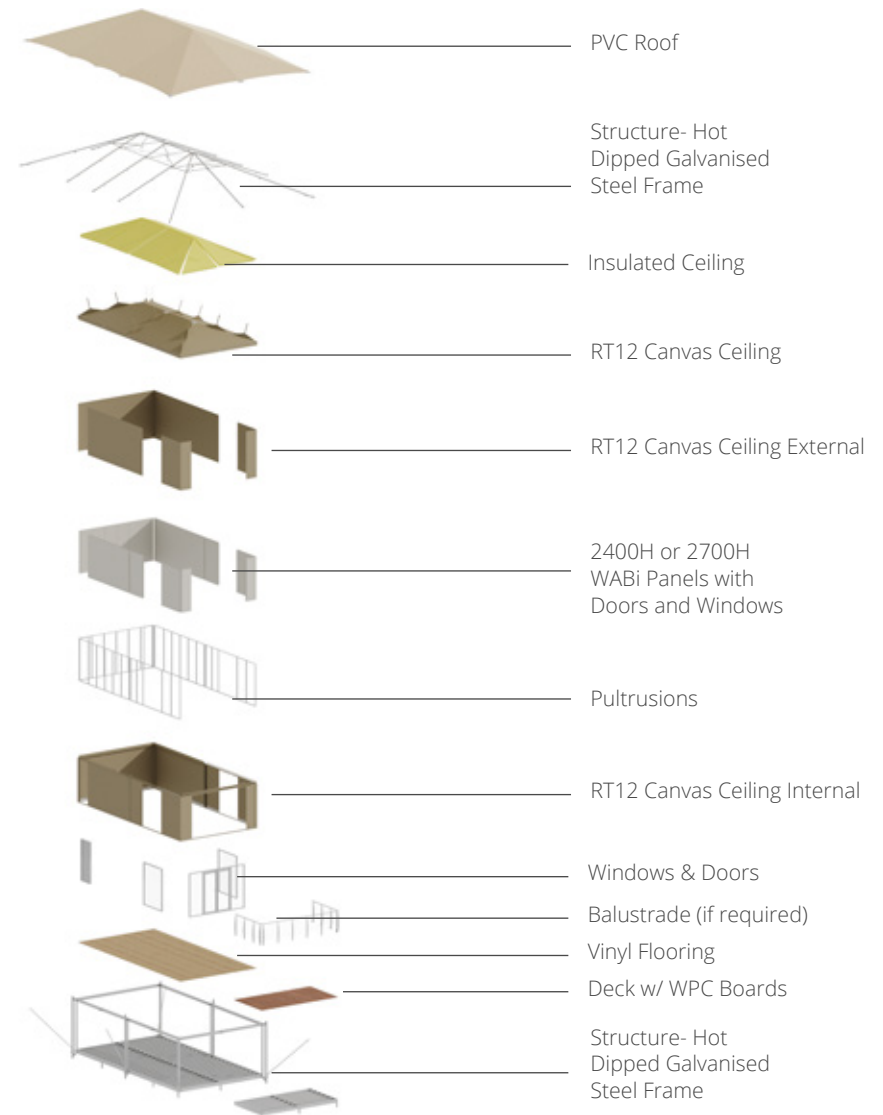

# HYBRID TENT WALLS

The WABi Panel is the highest performing proprietary structural insulated panel on the market.

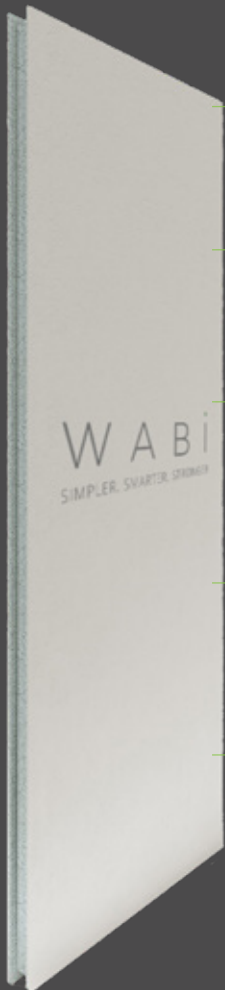

Superior air and water resistance



Up to 7 year warranty



PIR Insulation Core for high thermal efficiency



Use any external and internal cladding to finish



Extremely lightweight for easy installation

## THERMAL EFFICIENCY

Insulation rating R3.3.

## STRUCTURAL INTEGRITY

Panels are fully bonded for the highest cyclone rating in the world (Cyclonic Region D).

## ELECTRICAL & PLUMBING

Cabling and pipework runs between the panels, alleviating the need for complex and messy chasing or the installation of conduits.

## SAFE

- Require less maintenance
- Minimise additional insulation costs
- Fire resistance
- Hypoallergenic
- Moisture resistant

## EASE OF ASSEMBLY

Panels can be easily lifted into position by a small team. Joints are glued, with no requirements for mechanical fixings.

## INTERNAL & EXTERNAL FINISHES

Suitable for any finish, internal and external, including the fixing of alternative sheeting such as Colorbond or Hardiplank.

## COST EFFECTIVE

An investment saving clients on additional thermal insulation and heating and cooling expenses.

## INDUSTRY LEADING

This single product is a significant advancement and innovation in the building construction industry.



**x 165 more**

Thermally efficient than a single skin canvas wall



**x 30 Acoustic**

dB rating than a single skin canvas wall



**Structurally**

built as a house



Able to withstand **high wind** and **snow loads**

75mm





Eco Structures  
*NEXT STEPS*

# Typical Eco Structures *PROCESS*

You are **HERE**

1	Identify full project scope		-	Business vision, architecture & design, rooms & facilities, pricing, brief formation.
2	Formal quote developed & supplied		<b>1-2 month/s</b> <i>Variable due to clients variations</i>	Select one of our tent options and go through sketch design and development with our team
3	Project Specifications Signed		-	Drawings can only begin after the deposit has been paid 10% deposit
4	Drawing Process		<b>1 week</b> <i>Variable due to clients variations</i>	Formal Architectural drawings supplied with all requirements for the project including final colour selections & specifications
5	Manufacturing Drawings		<b>1-2 month</b>	Once we have received deposit we will proceed with engineering & manufacturing drawings
6	Manufacturing		<b>6-8 weeks</b>	Our Freight & Logistics team will keep you updated with emails and phone calls
7	Shipment		<b>4 weeks</b>	Computerized tracking systems and any paperwork you need for the duties & Taxes.
8	Delivery to site		<b>Variable</b>	Remote areas may require longer delivery times due to limited accessibility.
9	Installation		<b>4 days+ (per unit)</b> <i>Approx variable on local skills. Multiple tents can be installed simultaneously.</i>	Assisted online / on-site, depending on what your project requires

90 - 120 days

**10% deposit**

*Drawings can only begin after the deposit has been paid*

**40% progress claim**

*Manufacturing drawings can only begin after the progress claim has been paid*

**40% progress claim**



*Shipment can only begin after the progress claim has been paid*

**Final 10%**

*The final 10% is to be paid on arrival to your nearest port*

**WANT TO KNOW MORE?**

[ecostructures.com.au](http://ecostructures.com.au)

  @EcoStructures

24 Marine Terrace, Fremantle,  
Western Australia, 6160  
+61 8 9193 8007

GO BEYOND

A company of The WABi Group

WABi WABi WABi WABi  
SIMPLER, SMARTER, STRONGER DESIGN CONSTRUCTIONS WINDOWS